



PLANETA

LIFTING WITHOUT LIMITS



PREMIUM **23**

MANUAL LIFTING AND PULLING EQUIPMENT





PREMIUM PRO 1

PREMIUM PRO 5

Manual chain hoist PREMIUM PRO

Compact and light

The new PREMIUM-PRO chain hoist is the systematic development of the established PREMIUM series and is manufactured using the latest technology. Compared to its predecessors, it is much lighter and provides better handling thanks to its compact design.

Despite the weight saving, working stability has been improved thanks to the clever construction. The chrome-plated housing for corrosion protection and overload protection as standard reinforce the high quality of the PLANETA-PREMIUM PRO product.

Load chain

Tempered and galvanised load chain "Made in Germany" according to DIN EN 818-7-T. **Up to 3 t in a single strand.** Higher lifting on request, any length can be delivered.

Galvanised or powder-coated on all sides

Dirt or rain have no effect on this device. All connection and housing parts are protected against corrosion.

Chain mounting

Thanks to the easily-accessible chain mounting, any user can insert a longer chain if required.

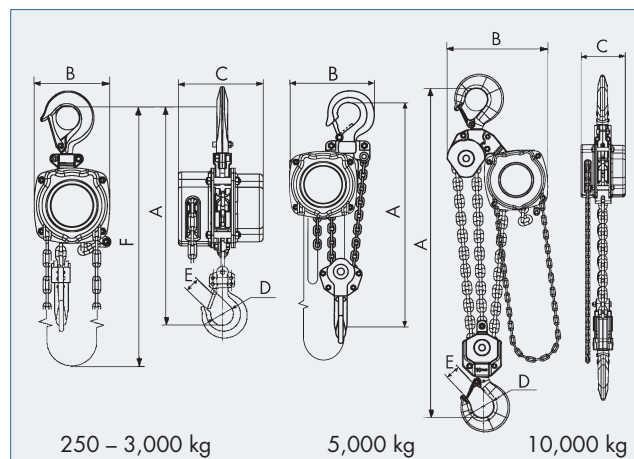

250 – 3,000 kg

5,000 kg

10,000 kg

TYPE	PREMIUM PRO ...	0.25	0.5	1	1.5	2	3	5	10	15	20	30	40
Capacity	kg	250	500	1,000	1,500	2,000	3,000	5,000	10,000	15,000	20,000	30,000	40,000
Standard lift	m	3	3	3	3	3	3	3	3	3	3	3	3
Min. headroom (A)	mm	285	316	367	409	428	504	637	735	1,036	1,031	1,149	1,557
Hand chain force	daN	22	22.1	33.2	32.3	43	40.6	33.8	45.1	36	38	40	40
Hand chain operation length	m	2.5	2.5	2.5	2.5	2.5	2.5	2.5	2.5	2.5	2.5	2.5	2.5
Meters hand chain to pull to lift 1 m	m	14.8	29.5	39.4	60.8	60.8	96.7	193.3	290	290	386.7	580	773.3
Number of chain falls		1	1	1	1	1	1	2	3	6	8	12	16
Chain size	mm	4 x 12	5 x 15	6 x 18	8 x 24	8 x 24	10 x 30	10 x 30	10 x 30*	10 x 30	10 x 30	10 x 30	10 x 30
B (Dimensions)	mm	102	122	152	176	176	216	259	344	441	432	532	961
C	mm	112	117	144	156	156	167	167	167	221	222	220	282
D	mm	35	35	44	48	50	59	68	91	97	106	150	216
E	mm	23	23	30	31	34	40	47	61	65	73	92	148
F	m	2.5	2.5	2.5	2.5	2.5	2.5	2.5	2.5	2.5	2.5	2.5	2.5
Weight with standard lift	kg	5.9	7.6	11.5	17.2	17.2	27	40.5	61.9	137.9	202.9	268.9	440
Weight for 1 m add. lifting height**	kg	1.2	1.4	1.7	2.3	2.3	3.1	5.3	7.5	14.9	19.3	28.1	36.9
PREMIUM PRO ... with 3 m lift	Order No.	G10310	G10311	G10312	G10313	G10314	G10315	G10316	G10317	G10308	G10318	G10319	G10309
Additional 1 m lift	Order No.	G10270	G10271	G10242	G10243	G10243	G10272	G10246	G10247	G10273	G10248	G10058	G10274
RFID-Chip incl. mounting	Order No.	G10600	G10600	G10600	G10600	G10600	G10600	G10600	G10600	G10600	G10600	G10600	G10600

* Grade 100 **1 m operating length and 1 m lift

Safety brake with two pawls hold the load in any position safely! All parts corrosion protected!

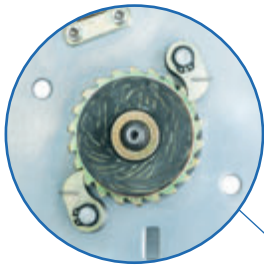

Extra brake dust cover

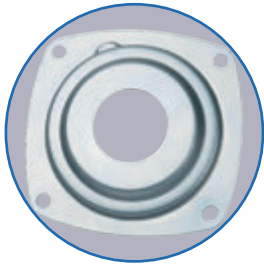

Standard overload protection (over 500 kg)

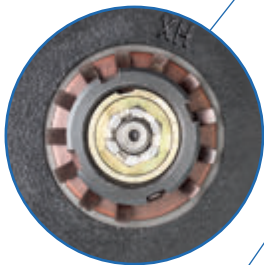

Chain mounting for lower terminal link



Tempered and galvanized load chain acc. DIN EN 818-7-T

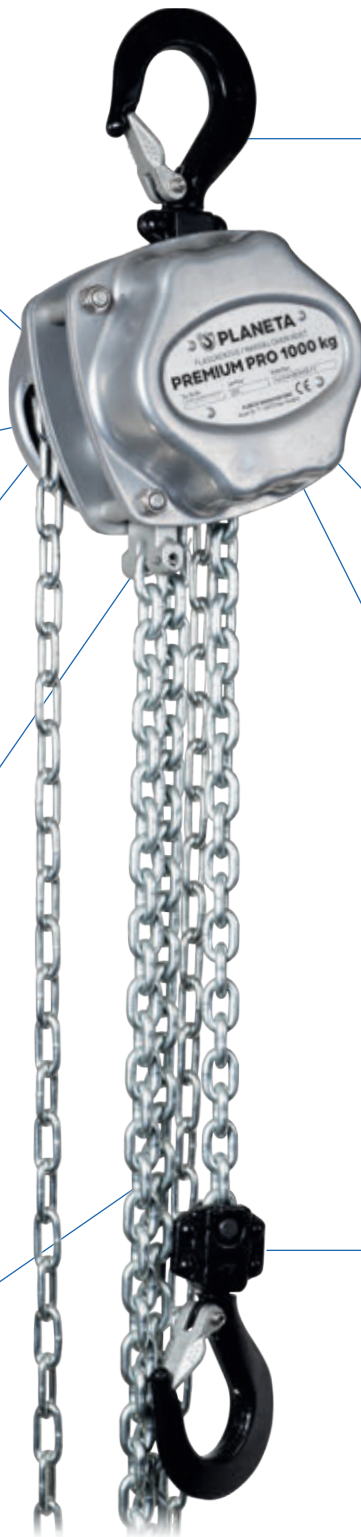
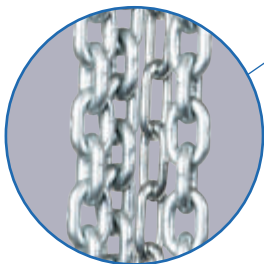

Swivelling top and bottom hook



3-fold bearing of the gearbox

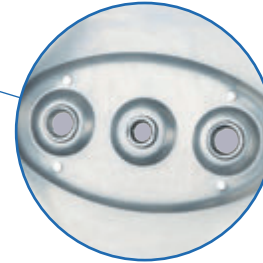

Powder-coated (RAL 9022) housing for best corrosion protection



Ball bearing mounted sprocket shaft



New cast hook clips



Option:
With RFID chip for digital equipment testing.



Options:

- Short model as a combination of chain hoist PREMIUM PRO and trolley
- Chain bag as an accessory
- Also available with GL (Germanischer Lloyd) certification! For shipyards, ships and the chemical industry.
- -Design

Option: Chain bag

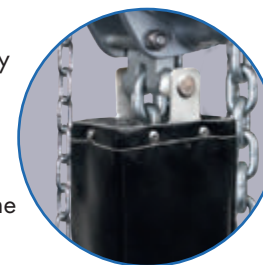

Chain bag (Plastic)	Chain bag size (max. lift in m)			Order No. 1	Order No. 2	Order No. 3
	1	2	3			
PREMIUM PRO 0.25	26	32	38	G10500	G10510	G10520
PREMIUM PRO 0.5	16	19	22	G10501	G10511	G10521
PREMIUM PRO 1	11	14	17	G10502	G10512	G10522
PREMIUM PRO 1.5	6	8	10	G10503	G10513	G10523
PREMIUM PRO 2	6	8	10	G10504	G10514	G10524
PREMIUM PRO 3	4	5	6	G10505	G10515	G10525
PREMIUM PRO 5	2	2.5	3	G10506	G10516	G10526
PREMIUM PRO 10	o. r.	o. r.	o. r.	G10507	G10517	G10527
PREMIUM PRO 20	o. r.	o. r.	o. r.	G10508	G10518	G10528
PREMIUM PRO 30	o. r.	o. r.	o. r.	G10509	G10519	G10529

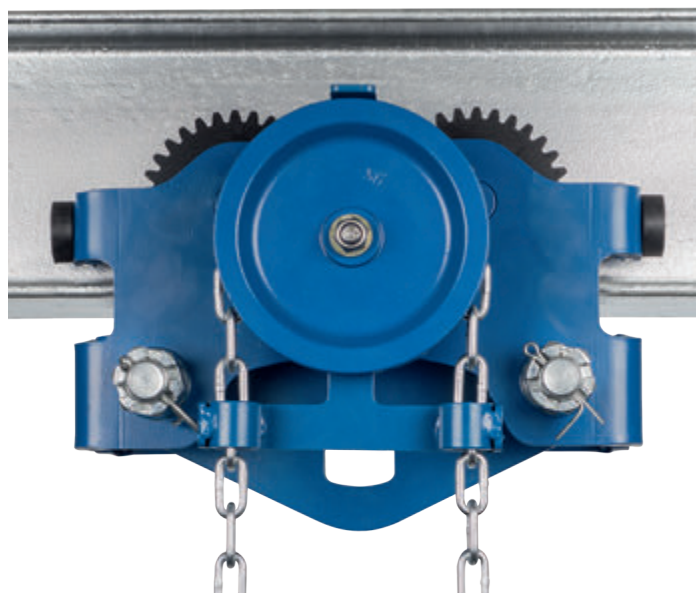

LST-H 0.5



LST-G 2



LST-Trolleys

LST-trolleys are manufactured in a higher quality for a very rough and unusual use.

The chain hoist PREMIUM PRO of the same capacity as the trolley fit easily into the lugs with their top hook, but these LST-trolleys are best combined with PREMIUM PRO. Trolleys have rubber buffers at both sides!

Wide adjustment for any flange width

Discs of different thicknesses are on the carrying bolts that allow to make the distance between side plates shorter or longer by exchanging them from outside to inside.

There are two main bolt lengths. The standard bolts are adjustable for normal width. Bolts of size 2 offer more possibilities up to beam flange sizes on HE-B-beams with 300 mm width. Prefer this when unclear for what kind of work you will use them.

Double safety

Climb stop on both side of the beam flange hinders the trolley to climb up the beam and prevents from falling down. Right angled side plates work as wheel shaft breakage protection, falling down protection and beam flange cleaner.

Sturdy side plates

The load is balanced by two carrying bolts on all four wheels because the castle nuts tie only one side. This gives the bolts a bit of tolerance for movement and equalizes improper beam flanges.

DESIGNS:

LST-H = Push trolley

LST-G = Gear type trolley

The manual trolleys shown are designed for use with manual hoists.

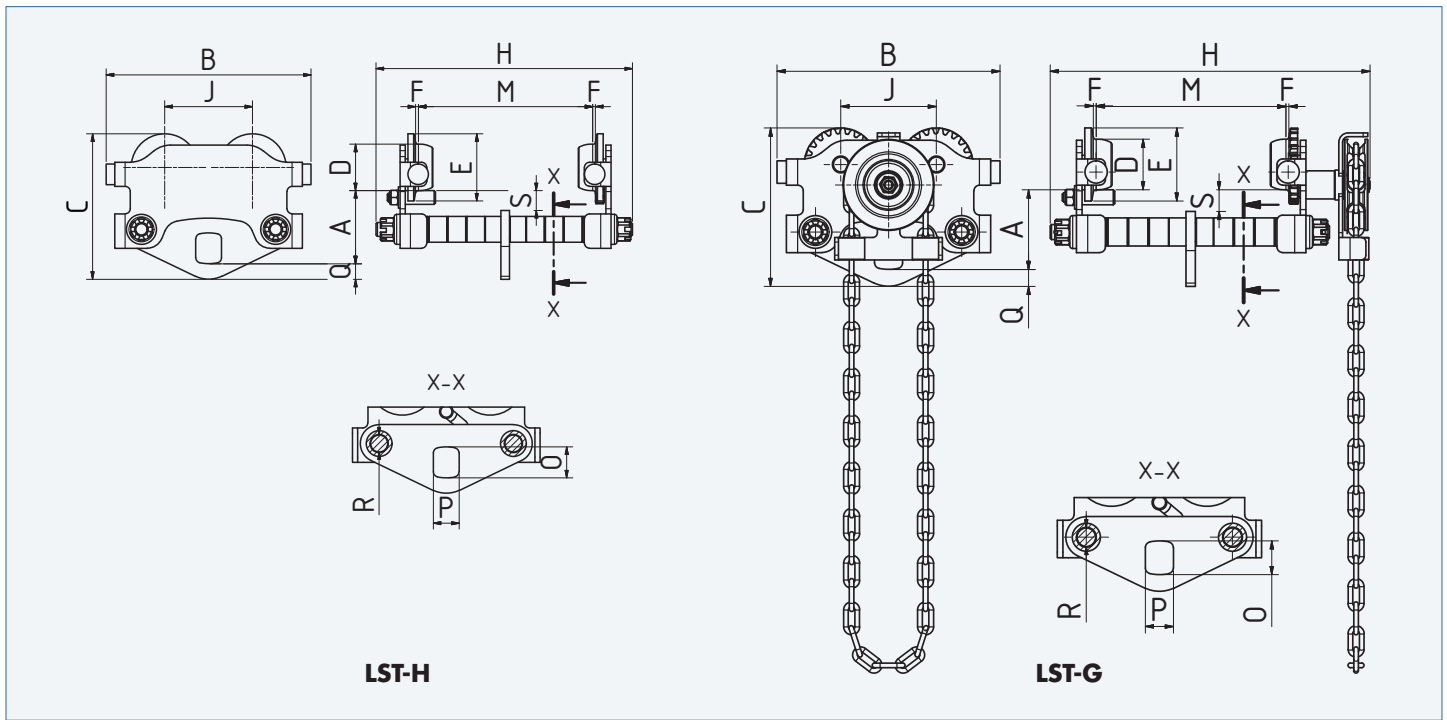

TYPE	LST-H ...	0.5	1	2	3	5	10	-
TYPE	LST-G ...	0.5	1	2	3	5	10	20
Capacity	kg	500	1,000	2,000	3,000	5,000	10,000	20,000
Flange width M min.-max.	mm	50-203	64-203	88-203	100-203	114-203	124-203	136-203
Min. curve radius	m	0.85	1	1.1	1.3	1.4	2	a.A.
Hand chain operation length LST-G	m	2.5	2.5	2.5	2.5	2.5	2.5	2.5
Reel path for 1 m path LST-G	m	2.96	3.63	4.65	5.66	6.34	7.98	10.63
A (Dimensions)	mm	85	103	115	125	143	187	250
B	mm	238	288	338	390	472	476	564
C	mm	169	207	237	271	307	381	514
D	mm	54	67	80	100	109	133	170
E	mm	78	96	111	133.5	145	176	228
F	mm	3	3	3	4	4	4	4
H (LST-H)	mm	298	314	325	355	381	388	-
H (LST-G)	mm	342	363	374	403	428	445	498
J	mm	102	112	131	153	168	194	234
O	mm	36	40	48	54	66	80	130
P	mm	30	36	40	46	52	64	100
Q	mm	18	22	26	29	37	40	65
R	mm	Ø 20	Ø 24	Ø 29	Ø 34	Ø 39	Ø 44	Ø 59
S	mm	23	24	28	26	28	50	55
Net weight LSTH	kg	9	14	22	36	55	86	-
Net weight LSTG	kg	11	16	24	39	59	89	190
LST-H	Order No.	G20340	G20341	G20342	G20343	G20344	G20345	-
LST-G with 2.5 m operation length	Order No.	G20350	G20351	G20352	G20353	G20354	G20355	G20356
Larger flange width min.-max.	mm	50 - 305	64 - 305	68 - 305	100 - 305	114 - 305	124 - 305	136 - 305
	Order No.	G20090	G20091	G20093	G20094	G20095	G20097	G20099
Add. operator length hand chain per m	Order No.	G20017	G20017	G20017	G20017	G20017	G20017	G20017
Position lock device	Order No.	G10180	G10181	G10182	G10183	G10184	G10185	G10186
Extended handwheel shaft	Order No.	G20360	G20361	G20362	G20363	G20364	G20365	G20366

More capacities on request!



HD3N-H-VZ

HD3N-G-VZ

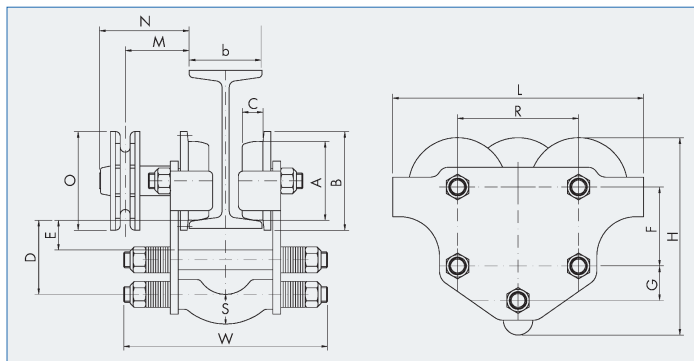

HD3N-Trolleys

Zinc plated design

HD3N-trolleys have outstanding corrosion protection. All steel parts are electrolytically zinc plated. This is a must in wet rooms and in very aggressive environment. Larger flange width (size 2 - 4) are optional. Wheels fit flat and also tapered flanges!

Capacities up to 25 t on request.

Many special version upon request.

- NIROSTA - trolleys up to 3 t
- Bogie trolleys up to 10 t
- Rack gear trolleys up to 12.5 t
- Person transporting trolleys - acc. EN 1808 up to 4 t capacity



1m more operation length	Order No.
Standard zinc plated (2.5 m total)	G20118

TYPE	HD3N-H-VZ ...	0.5	1	2	3.2	5	6.3	8*	10	12.5	20
TYPE	HD3N-G-VZ ...	-	1	2	3.2	5	6.3	8*	10	12.5	20
Capacity	kg	500	1,000	2,000	3,200	5,000	6,300	8,000	10,000	12,500	20,000
Maximum weight of hoist	kg	100	120	250	150	300	200	550	600	150	800
Flange width b	min. / max. size 1 mm	55/102	55/102	74/127	90/143	106/156	106/156	106/166	131/195	143/222	170/212
	min. / max. size 2 mm	105/152	105/152	127/180	149/203	160/210	160/210	167/247	196/271	223/298	-
	min. / max. size 3 mm	-	156/203	190/243	203/254	210/260	210/260	248/349	272/363	299/389	-
	min. / max. size 4 mm	-	207/254	254/305	251/305	255/305	255/305	-	-	-	-
Hand chain force	daN	-	10	16	25	20	25	16	19	23	25
Hand chain operation length	m	2.5	2.5	2.5	2.5	2.5	2.5	2.5	2.5	2.5	2.5
Min. curve radius	m	1	1.5	1.6	2	2.9	2.9	3.5	3.5	3.5	5.5
A (Dimensions)	mm	45	60	80	100	125	125	160	160	160	200
B	mm	60	75	100	120	150	150	190	190	190	240
C	mm	15	18	22	25	30	30	35	35	35	50
D	mm	52	60	75	90	117	117	145	145	145	165
E	mm	15	20	27	35	40	40	45	45	45	42
F	mm	45	60	80	100	120	120	145	145	145	165
G	mm	30	30	35	40	60	60	80	80	80	100
H	mm	125	150	195	235	295	300	365	370	375	450
L	mm	150	190	255	300	375	375	450	450	450	550
M	mm	-	65	65	70	100	100	115	115	115	135
N	mm	-	90	90	95	130	130	135	135	135	170
O	mm	-	100	100	100	135	135	270	270	270	300
W	size 1 mm	160	170	215	250	275	275	b + 150	b + 150	b + 150	b + 185
	size 2 mm	210	220	265	310	330	330				
	size 3 mm	-	270	330	360	380	380				
	size 4 mm	-	325	390	410	425	425				
R	mm	75	99	123	144	174	174	220	220	220	272
S	size 1 mm	20	20	30	35	40	45	40	50	55	65
	size 2 mm	20	25	35	40	45	50	45	55	60	-
	size 3 mm	-	30	35	40	50	55	50	60	65	-
	size 4 mm	-	30	40	45	50	55	-	-	-	-
Net weight HD3N-H-VZ	kg	3	5	11	18	33	35	85	90	95	150
Net weight HD3N-G-VZ	kg	-	6	12	19	35	36	90	95	100	160
HD3N-H-VZ	Order No.	G20230	G20231	G20232	G20233	G20234	G20235	G20236	G20256	G20257	G20285
HD3N-G-VZ with 2.5 m operation length	Order No.	-	G20237	G20238	G20239	G20240	G20241	G20242	G20258	G20259	G20286
Larger flange width size 2-4	Order No.	G20243	G20244	G20245	G20246	G20247	G20248	-	-	-	-

* From 8 t version: Surface painted, color RAL 7021. / **The trolleys shown are designed for use with manual hoists.**

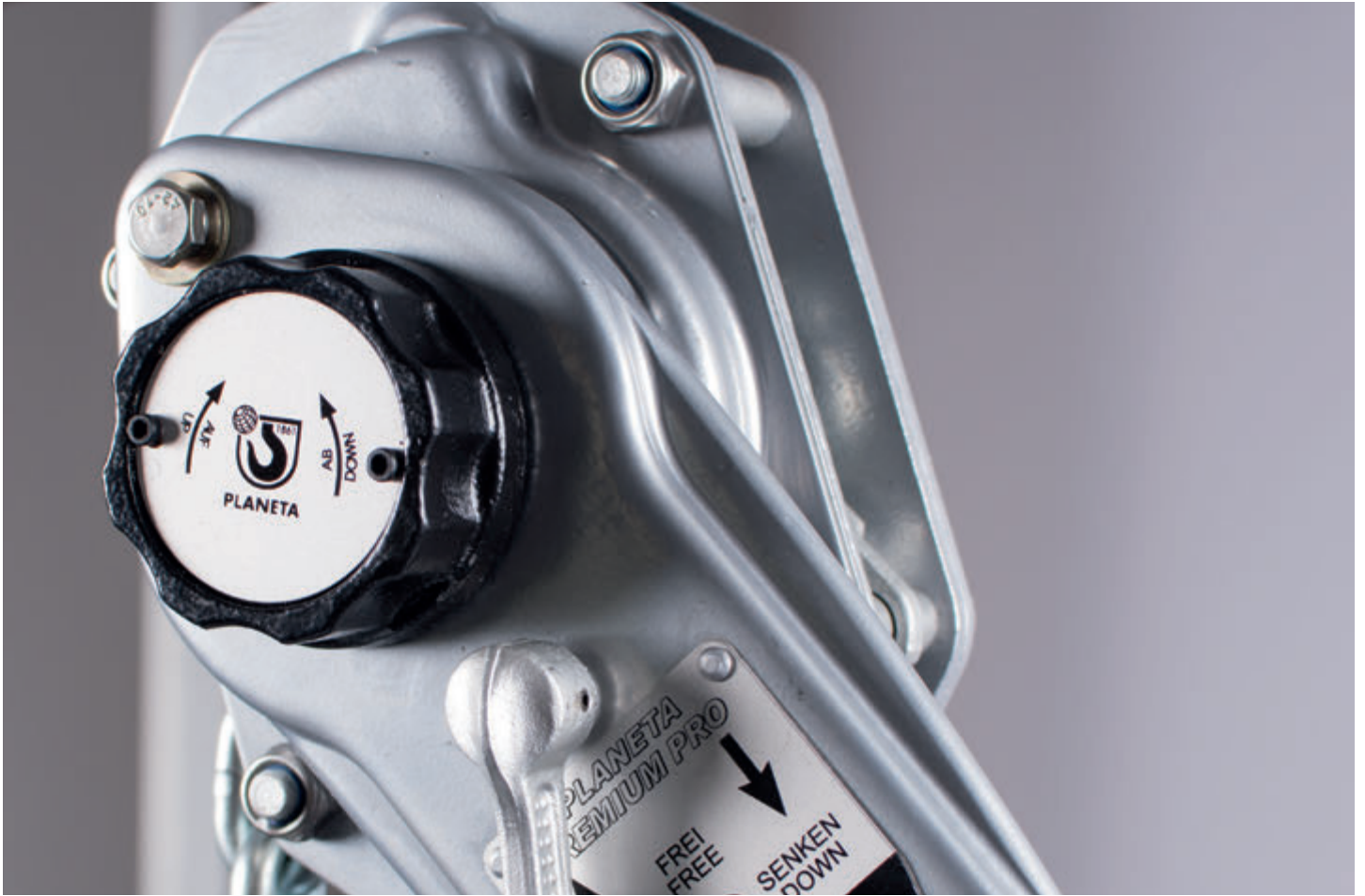



LHT-H 005L



LHT-G 005L



Combined power

Saving headroom

The very best manual chain hoist PREMIUM PRO and a trolley LST are put together in an integrated combination to save headroom. That means the distance between load point of hook and bottom of beam flange. This is very important if rooms are low or space is narrow. Halls can be build smaller what saves costs. Or if the clearance in older buildings is too narrow for standard hoists – this is the solution!

Advantages of trolley hoist

- shortens downtime in ships
- enables low cost bridge cranes
- labor saving during repair and maintenance works.
- optimal space utilisation

Low headroom trolley hoist LHT

The close combination of hoist and trolley with low headroom offers a unit that is both functional and versatile. There is less timespent messing with equipment and money is saved. The LHT-line uses the quality advantages of the PREMIUM PRO manual chain hoists. The smoothly moving and operation on ball bearings plus a perfectly finish of surface protection offers the user an uncomparable reliability. The standard equipped overload protection fulfills even the high demands on ocean going vessels.

Designs:

- LHT-H** = Chain hoist in push trolley
- LHT-G** = Chain hoist in gear type trolley

Standard version:

- PREMIUM chain hoist with 3 m lift and 2.5 m hand chain operation length
- Available as manual push trolley (TYPE -H) or geared trolley (TYPE -G)
- A contour trolley wheel design provides maximum beam contact on flat or tapered beams. Tilting and climbing protection according CE-regulations are self-evident.

Options (on request):

- Chain case (what is very unusual for manual chain hoists) for down-hanging loose chain that may cause trouble in some cases.
- For corrosive environments, completely zinc plated surfaces are also available for the trolley
- Special non-corrosive and non-sparking steels for chain
- Special flange widths of up to 305 mm are possible if the specified adjustment range (dimension H) is no longer sufficient.
- Low headroom trolley hoist with position lock device

TYPE	LHT...-H/-G	005L	010L	015L	020L	030L	050L	100L	200L
Capacity	kg	500	1,000	1,500	2,000	3,000	5,000	10,000	20,000
Standard lift	m	3	3	3	3	3	3	3	3
Number of chain falls		1	1	1	1	1	2	3	8
Chain size	mm	5 x 15	6 x 18	8 x 24	8 x 24	10 x 30	10 x 30	10 x 30*	10 x 30
Min. headroom (A)	mm	268	318	388	388	472	595	800	965
Beam flange width min.-max. (M)	mm	50-203	64-203	88-203	88-203	100-203	114-203	124-203	136-203
Min. curve radius	m	0.85	1	1.1	1.1	1.3	1.4	2	3.5
Meters hand chain to pull to lift 1 m	m	29.5	39.4	60.8	60.8	96.7	193.3	290	386.7
Reel path for 1 m path LHT-G	m	3	3.6	4.7	4.7	5.7	6.3	8	10.6
Dimension H min. LHT-H	mm	298	314	325	325	355	381	388	-
Dimension H min. LHT-G	mm	342	363	374	374	403	428	445	498
B	mm	238	288	338	338	390	472	476	564
C	mm	352	420	487	487	566	745	940	1165
D	mm	54	67	80	80	100	109	133	170
E	mm	78	96	111	111	133.5	145	176	228
F	mm	3	3	3	3	4	4	4	4
G	mm	∅ 38	∅ 44	∅ 50	∅ 50	∅ 63	∅ 60	∅ 75	∅ 120
J	mm	102	112	131	131	153	168	194	234
K	mm	24	28	31	31	40	40	48	96
R	mm	∅ 20	∅ 24	∅ 29	∅ 29	∅ 34	∅ 39	∅ 44	∅ 59
S	mm	23	24	28	28	26	28	50	55
Weight with 3 m lift LHT-H	kg	13.5	22	42	42	56	82	143	331
Weight with 3 m lift LHT-G	kg	14.8	23.5	43.7	43.7	58	85	148	353
LHT-H with 3 m lift	Order No.	G20300	G20301	G20302	G20303	G20304	G20305	G20307	G20309
Additional 1 m lift (LHT-H)	Order No.	G10271	G10242	G10243	G10243	G10272	G10246	G20077	G20079
LHT-G with 3 m lift	Order No.	G20310	G20311	G20312	G20313	G20314	G20315	G20317	G20319
Additional 1 m lift (LHT-G)	Order No.	G20320	G20321	G20322	G20323	G20324	G20325	G20327	G20329
Position lock device	Order No.	G10180	G10181	G10182	G10182	G10183	G10184	G10185	G10186
Larger flange width (M) min.-max.	mm	64-305	64-305	88-305	88-305	100-305	114-305	124-305	136-305
	Order No.	G20090	G20091	G20092	G20093	G20094	G20095	G20097	G20099

Chain bag (plastic) on request.

* Grade 100

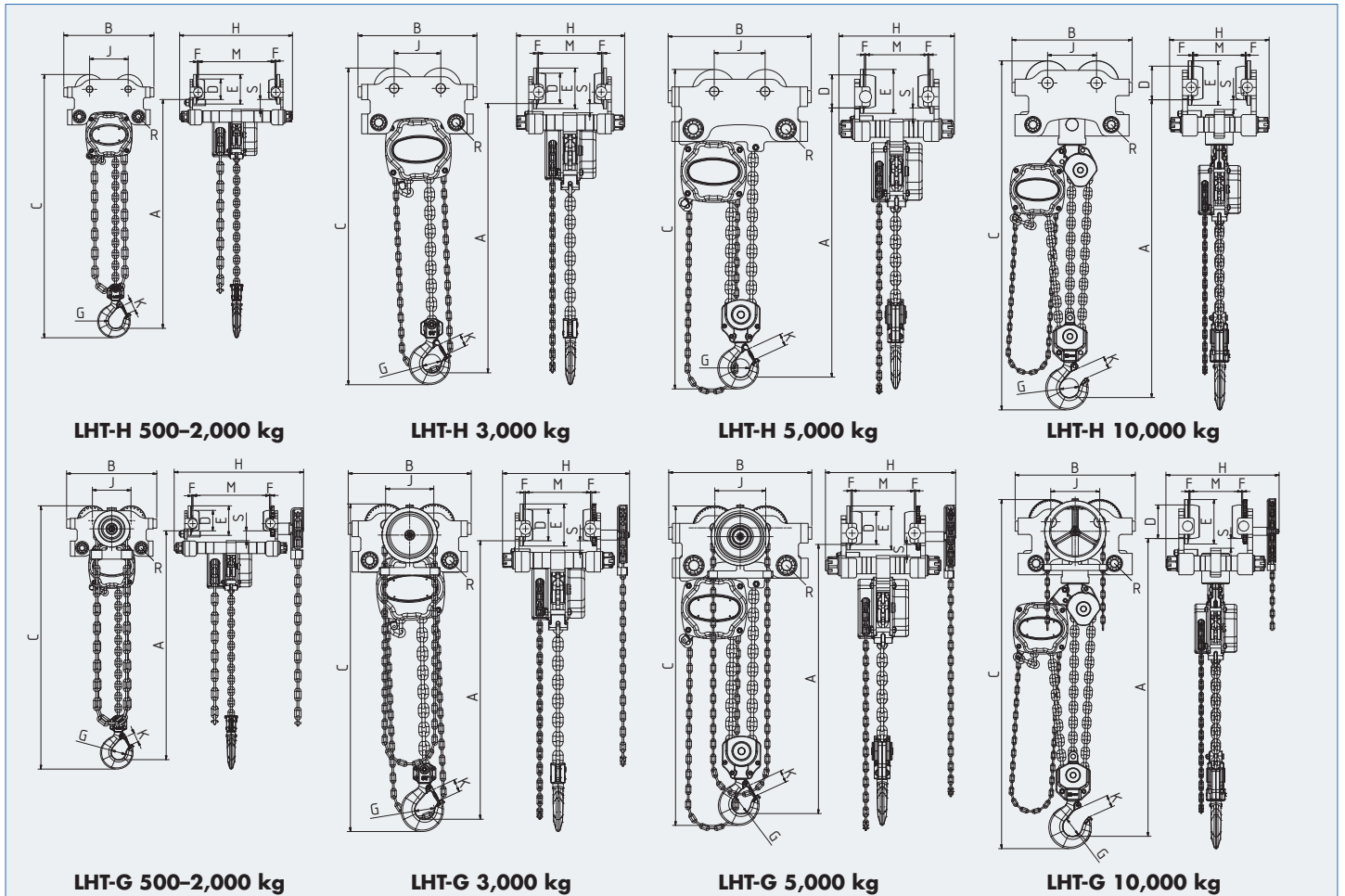

Lifting trolley LHT-Hyperlow

Extremely short design

The PKB trolley is an extremely compact combination hoist, consisting of trolley and integrated chain hoist, with a very low overall height. The load hook is pulled directly under the flange of the girder - you can't get any shorter for single girder trolleys!

Features

- Low weight
- Extremely low overall height
- Low effort required for hand chain operation
- Double safety catches
- 2-layer surface finish in RAL 5010

Quality features

A solid steel construction with proven standard hoist components (including overload protection).

Basic equipment

- Contoured wheel profiles for flat and inclined beams.
- Quenched and tempered and galvanised load chain with the properties of DIN EN 818-7-T, hand chain in galvanised design.
- Standard lift 3 m and hand chain operating length 2.5 m.
- Comprehensive operating instructions and test book.

Special equipment

Special ATEX protection with bronze parts and galvanisation, chain bag, locking device: on request.

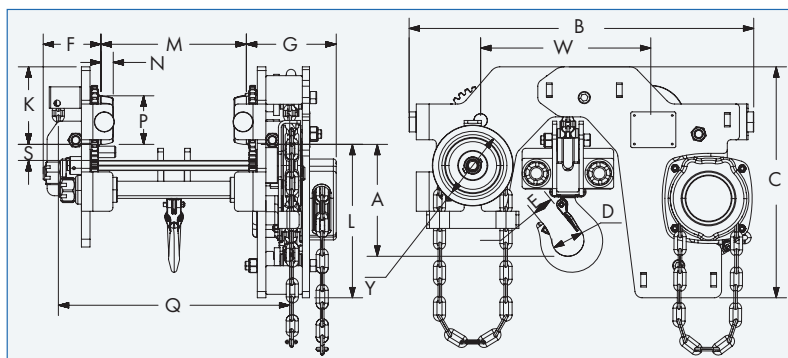
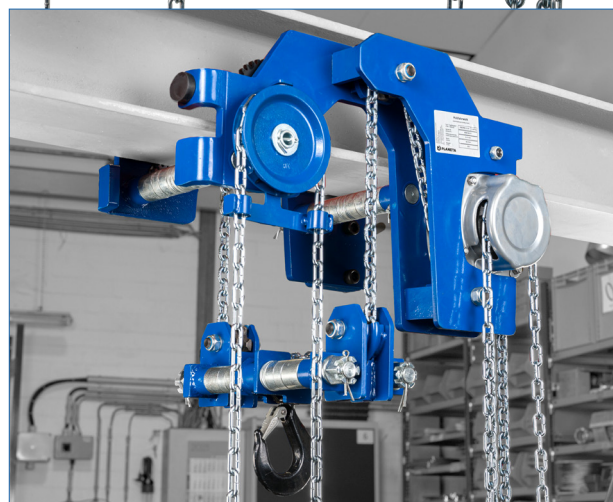

TYPE	LHT-Hyperlow ...	10	20	32	63	100
Capacity	kg	1,000	2,000	3,200	6,300	10,000
Standard lift	m	3	3	3	3	3
Number of chain falls		2	2	2	2	4
Chain size	mm	5 x 15	6 x 18	8 x 24	10 x 30	10 x 30
Hand chain force	daN	29.5	33.2	34.4	43.2	33.8
Min. Headroom (A)	mm	156	173	212	249	305
Beam flange width min.- max. (M)	mm	64 – 203	88 – 203	100 – 203	114 – 203	124 – 203
Meters hand chain to pull to lift 1 m	m	59.06	78.76	121.52	193.33	386.68
Reel path for 1 m path	m	3.575	4.630	5.643	5.708	6.701
B (Dimensions)	mm	482	569	647	738	916
C	mm	323	393	487	592	580
D	mm	45	50	58	68	91
E	mm	30	34	38	47	61
F	mm	81	91	111	135	160
G	mm	126	154	162	194	192
K	mm	108	138	165	214	196
L	mm	215	254	322	378	384
N	mm	17	20	24	33	37
P	mm	68	80	100	109	133
Q	mm	324	340	381	427	426
S	mm	22	22	21	24	28
W	mm	238	280	330	375	480
Y	mm	95.5	127.3	159.2	160	222.8
Weight with standard lift	kg	59	68.8	139	227.5	340.7
Weight for 1 m add. lifting height	kg	2.8	3.3	4.5	6.1	10.5
LHT-Hyperlow with 3 m lift	Order No.	G20380	G20381	G20382	G20383	G20385
Additional 1 m lift	Order No.	G20390	G20391	G20392	G20393	G20395

Aluminium lever hoist PAH

The new PLANETA PAH aluminium ratchet lever hoist is an essential tool in industrial and service applications thanks to its very small and light design.

A closed, well-designed aluminium die-cast housing protects the inner components against dirt. Equipped with two robust hook clips, the PAH meets all safety requirements and guarantees safe work.

The new robust chain end piece provides additional safety because the chain cannot be pulled through the device in this way.

A release lever enables the chain to be pulled through quickly when not under load.

Usable at ambient temperatures from -20 °C to +60 °C.

Tempered and galvanized chain according to DIN EN 818-7-T.

Hand lever with rubber handle (only for 250 kg/500 kg load bearing capacity)

The standard lift is 1.5 m

Option: With RFID chip for digital equipment testing.

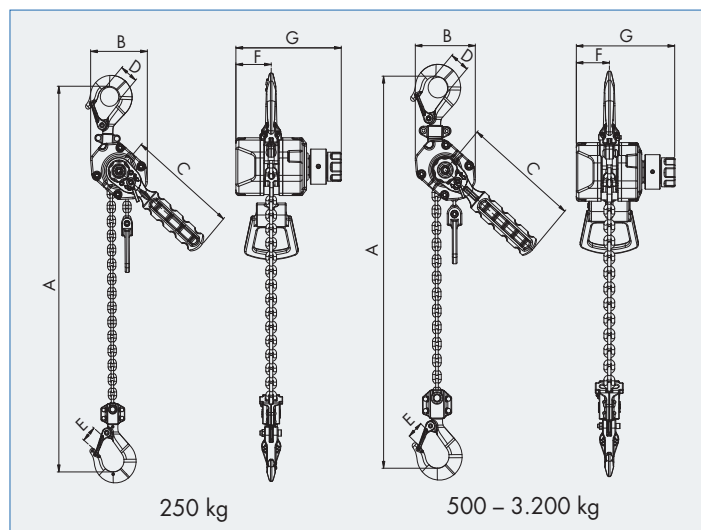

PAH 250



PAH 1600



TYPE	PAH ...	250	500	800	1600	3200
Capacity	kg	250	500	800	1,600	3,200
Standard lift	m	1.5	1.5	1.5	1.5	1.5
Min. headroom (A)	mm	223	282	329	355	445
Lever force	daN	17	20	22	25	34
Number of chain falls		1	1	1	1	1
Chain size	mm	3 x 9	4 x 12	5.6 x 17	7.1 x 21	9 x 27*
B (Dimensions)	mm	74	90	115	140	170
C	mm	142	175	233	233	350
D	mm	30	35	39	44	60
E	mm	20	22	28	30	41
F	mm	36	40	55	70	88
G	mm	105	117	140	158	185
Weight with standard lift	kg	1.6	2.7	5.1	7.6	14.7
Weight for 1 m additional lifting height	kg	0.2	0.4	0.7	1.1	1.8
PAH ... with 1.5 m lift	Order No.	G10460	G10461	G10462	G10463	G10464
Additional 1 m lift	Order No.	G10465	G10007	G10086	G10087	G10249
RFID-Chip incl. mounting	Order No.	G10601	G10601	G10601	G10601	G10601

* Grade 100

**Incl. practical bag
for the models
PAH 250 & 500**





Lever hoist PLANETA - PREMIUM PRO

The next development stage of the reliable PREMIUM lever hoist is the PREMIUM PRO. Thanks to a significant weight saving, handling is improved. Despite this, the frame has been strengthened compared to the previous generation. Proven quality also ensures longevity and its design makes it very robust.

Free-running mode

When the selection switch is moved to the middle point, the unladen chain can easily be pulled through the device freely to the required usage length. This makes tensioning the chain easier.

Load chain

The tempered, galvanised load chain according to DIN EN 818-7-T is supplied with the unit. The standard lifting height is 1.5 m; any length required for higher lifting is possible.

New chain end piece

The robust chain end piece provides additional safety because it cannot be pulled through the device with the chain.

Protected handle

The ergonomic rubber handle on the end of the lever protects the user against injury and is also screwed in place to prevent it slipping.

Technical advantages

Hand lever can be used in any position thanks to the ratchet; safety automatic mechanical brake; galvanised connecting parts; cast hook clip; large, non-slip and closed hand wheel; safety chain end piece, approved for load securing according to EN 12195-3.

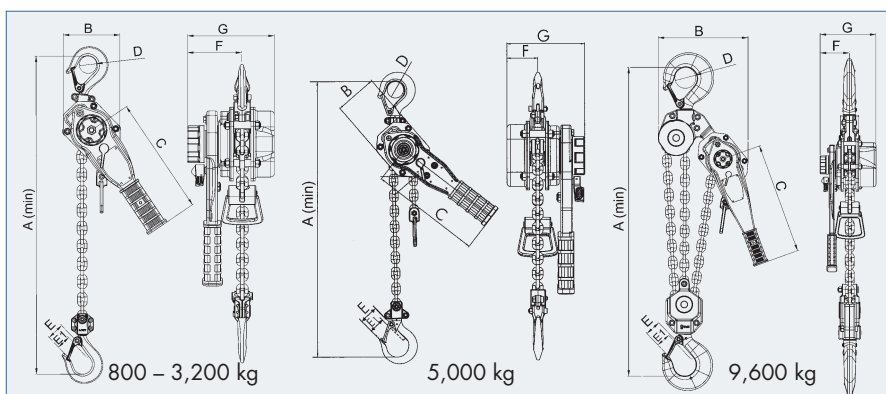

TYPE	PREMIUM PRO ...	0.8	1.6	3.2	5**	6.4	9.6
Capacity	kg	800	1,600	3,200	5,000	6,400	9,600
Standard lift	m	1.5	1.5	1.5	1.5	1.5	1.5
Min. headroom (A)	mm	320	360	431	655	500	635
Lever force	daN	22	24	33	37	36	38
Meters load chain movement with 1 round 360°	m	0,019	0,015	0,016	0,009	0,008	0,005
Number of chain falls		1	1	1	1	2	3
Chain size	mm	5.6 x 17	7.1 x 21	9 x 27*	13 x 36	9 x 27*	9 x 27*
B (Dimensions)	mm	115	137	169	180	238	300
C	mm	239	259	374	400	374	374
D	mm	35	42	48	60	60	70
E	mm	35	38	46	43	59	54
E1	mm	23	28.5	33	41	39	51
F	mm	91	67	98	104	98	98
G	mm	146	162	187	213	187	187
Weight with standard lift	kg	6.3	8.8	16.4	32.5	24.9	42.1
Weight for 1 m additional lifting height	kg	0.7	1.1	1.8	3.7	3.6	5.4
PREMIUM PRO ... with 1.5 m lift	Order No.	G10390	G10391	G10392	G10280	G10394	G10395
Additional 1 m lift	Order No.	G10086	G10087	G10249	G10287	G10254	G10256
Chain inhibit lock	Order No.	G10450	G10451	G10452	G10453	G10452	G10452
RFID-Chip incl. mounting	Order No.	G10600	G10600	G10600	G10600	G10600	G10600

* Grade 100 ** chromated

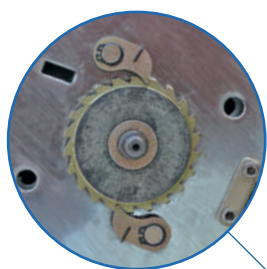

Safety brake with two pawls



Large, non-slip hand wheel

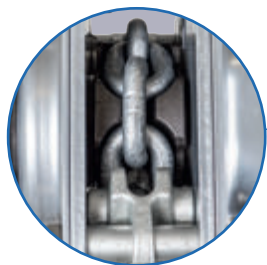

Integrated chain guide



Reversing lever with free-running mode



Powder-coated (RAL 9022) housing for best corrosion protection ** (5 t chromated)



Extra-secure handle



Chain end piece with robust plastic design



Option:
The optional chain inhibit lock prevents the load chain slipping through the hoist housing.



Option:
With RFID chip for digital equipment testing.



Drop-forged load hook with closed and fitting safety latch





PLANETA - Hebetchnik GmbH

Resser Straße 17
44653 Herne
Germany

Phone: +49 (0) 2325 9580 0
Fax: +49 (0) 2325 77077

E-Mail: info@planeta-hebetechnik.de
Internet: www.planeta-hebetechnik.de

